

# WD-5400 Series Self-Loading Dolly Owners Manual

- WD-5400A Self-Loading Step-latching design, with 4.80x8 Tires and Standard Adjustable Aluminum Axles.  
 WD-5400A-2 Self-Loading Step-latching design, with 4.80x8 Tires and Dual Skid-pad Adjustable Aluminum Axles.
- WD-5400LA Self-Loading Step-latching design, with 5.70x8 Tires and Adjustable Aluminum Axles.  
 WD-5400LA-2 Self-Loading Step-latching design, with 5.70x8 Tires and Dual Skid-Pad Adjustable Aluminum Axles.
- WD-5400 Self-Loading Step-latching design, with 4.80x8 Tires and Standard Adjustable Steel Axles.  
 WD-5400-2 Self-Loading Step-latching design, with 4.80x8 Tires and Dual Skid-pad Adjustable Steel Axles.
- WD-5400L Self-Loading Step-latching design, with 5.70x8 Tires and Adjustable Steel Axles.  
 WD-5400L-2 Self-Loading Step-latching design, with 5.70x8 Tires and Dual Skid-Pad Adjustable Steel Axles.

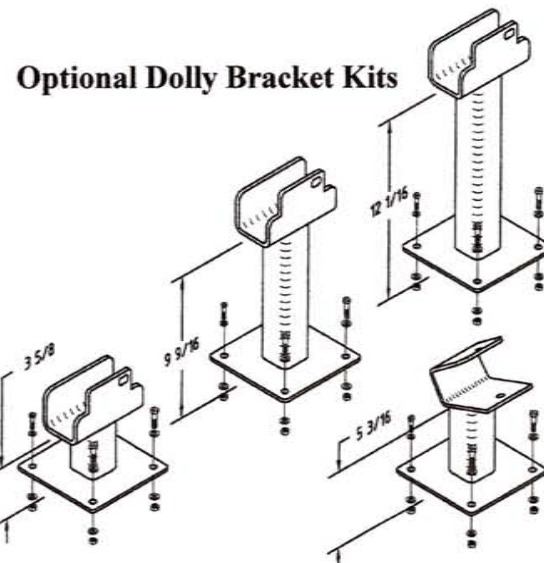
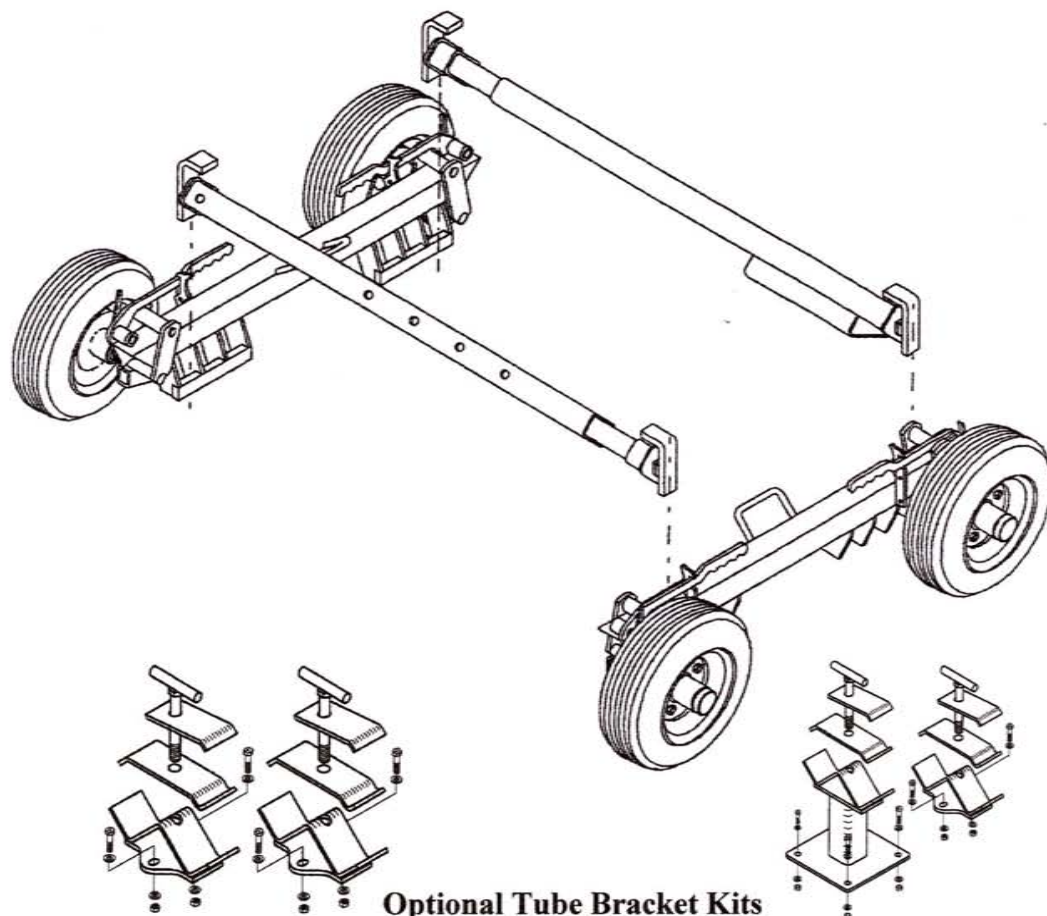

## CAUTION:

Read and follow Owners Manual carefully before operating dollies.  
 Keep BOTH HANDS firmly on the lift bar while raising or lowering the dolly.  
 Always keep your HANDS and FEET out from under the dolly.  
 Always load vehicle on a level surface.  
 Always use tie-down straps to secure the dolly to the towed vehicle.  
 Always drive safely and follow SAFE TOWING PRACTICES.  
 Follow preventative maintenance requirements for proper operation.

## Diversified Products Mfg.

8330 Atlantic Blvd, Jacksonville Fl. 32211  
 800-874-4172, 904-724-0310, Fax 904-724-4494

# WD-5400 Series Self-loading Dolly Owners Manual

## TO LOAD VEHICLE ONTO THE SELF LOADING DOLLY:

- 1) Adjust the length of the axle tubes by carefully depressing the plunger and sliding the tube in or out. Lock it in the shortest position wider than the vehicle being towed. Both Axles must be locked at the same length.
- 2) Place the axle tubes under the vehicle with the skid plate(s) facing the tires.
- 3) Place a Side Frame at each end of the axle tubes. The wheel side of the frame must face away from the towed vehicle.
- 4) To assemble the dolly, the wheels of the Dollies must first be in the loading position (unlatched). To accomplish this, disengage the step latch located at each end of the side frame (see fig. 2). DISENGAGE THE RELEASE HANDLE LATCH (fig. 3) and pull up on the release handle thus freeing the spindle and allowing the frame to drop to the ground. Return the step latch to the engaged position (see fig. 2).
- 5) Tilt the side frame slightly away from vehicle. Insert the axle ends into the slots on the side frame (see fig. 1). Use the slot positions closest to the towed vehicles tires, (i.e. the narrowest usable setting).
- 6) Spread the dolly tires apart, and insert the end of the lift bar into the lift bar tube located on the tire spindle.
- 7) With BOTH HANDS firmly on the lift bar, rotate the lift bar up and all the way around, past each stop on the step-latch, until the tire spindle is fully engaged by the Release Handle and the Release Handle is in the horizontal position (see fig. 2). The lift bar must be rotated all the way around for the spindle to engage the release handle and for the release handle to become horizontal.
- 8) Engage the Release Handle Latch (see fig. 3). If the release handle is not horizontal, then the dolly is not fully raised and the Release Handle Latch will not engage properly. Do not bend or force the release handle or the release handle latch. Do not tow the dolly without fully raising the dolly and engaging the release handle latch.
- 9) Remove the lift bar. Repeat steps 6, 7, 8 & 9 for each remaining dolly wheel.
- 10) Before towing, secure both tires of the towed vehicle to the dolly using tie down straps (see fig. 4).

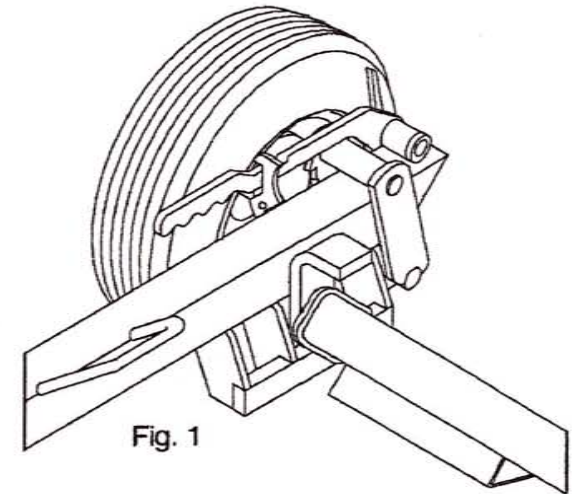

Fig. 1

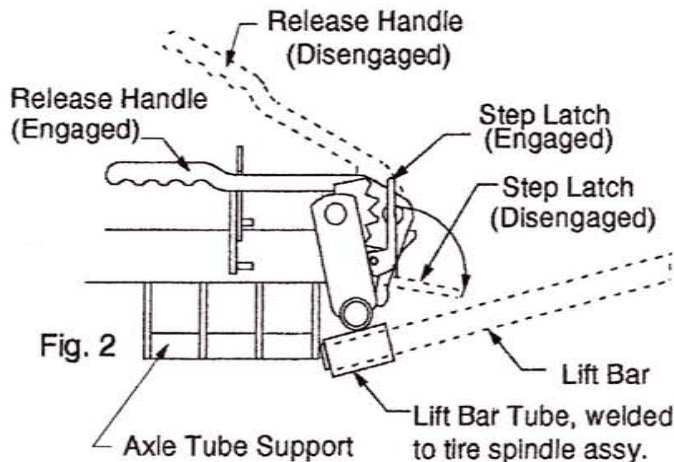

Fig. 2

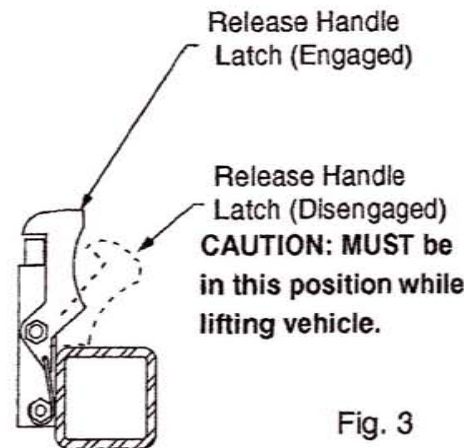

Fig. 3

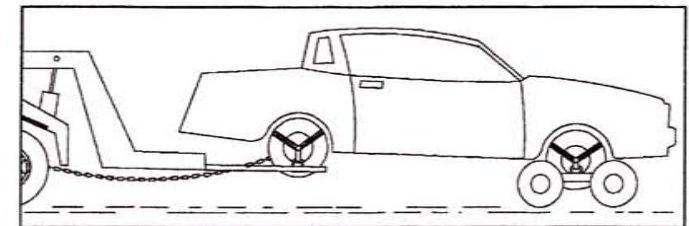

Fig. 4

**Diversified Products Mfg.**

8330 Atlantic Blvd, Jacksonville FL 32211  
800-874-4172, 904-724-0310, Fax 904-724-4494

Rev. 7-2009

# WD-5400 Series Self-loading Dolly Owners Manual

## TO UNLOAD THE VEHICLE FROM THE SELF LOADING DOLLY:

### SOFT RELEASE METHOD (RECOMMENDED)

- 1) Remove the tie down straps.
  - 2) Disengage the step latch (fig. 2).
  - 3) Insert the lift bar into the lift bar tube (see fig. 2). While firmly holding the lift bar with one hand, disengage the release handle latch, then raise the Release Handle and slowly raise the Lift Bar until the wheel spindle clears the Release Handle.
  - 4) IMMEDIATELY PLACE BOTH HANDS ON THE LIFT BAR, and move your hands towards the far end of the bar. Position your body to avoid the lift bar, and to use your body weight to control the lift bar while you rotate the lift bar up and over until the sideframe is on the ground.
- NOTE: Controlling the load as it lowers requires both hands firmly near the end of the lift bar, and properly positioning your body to maintain control of the descent
- 5) Repeat the above on the remaining three wheels.

### QUICK RELEASE METHOD (CAUTION: This method will allow the vehicle to drop IMMEDIATELY.)

- 1) Remove the tie down straps.
- 2) Disengage the step latch (see fig. 2).
- 3) Disengage the release handle latch (see fig. 3).
- 4) CAUTION: Keep your hands and feet clear of the dolly sideframes and axle tubes and ensure that there is no obstruction beneath the towed vehicle or dolly before proceeding.
- 5) While keeping your hand and arm directly above the dolly sideframe, lightly lift the end of the release handle, allowing that end of the sideframe to drop to the ground. CAUTION: Allow the release handle to be pulled from your grasp as the sideframe falls to the ground. DO NOT attempt to hold on to the release handle as it drops.
- 6) Repeat the procedure for the remaining 3 dolly wheels.

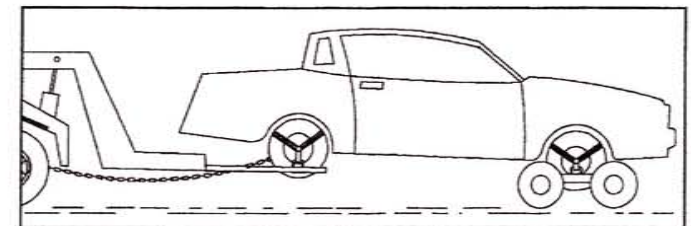
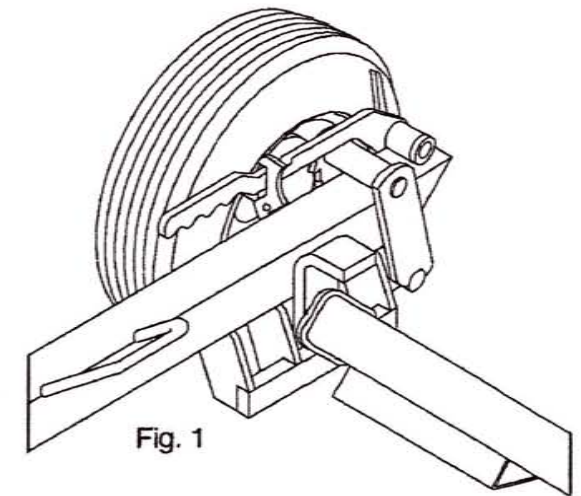
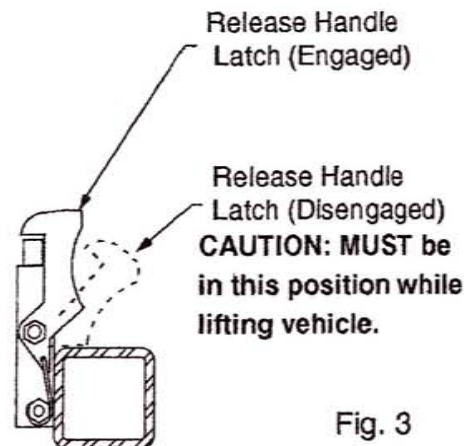
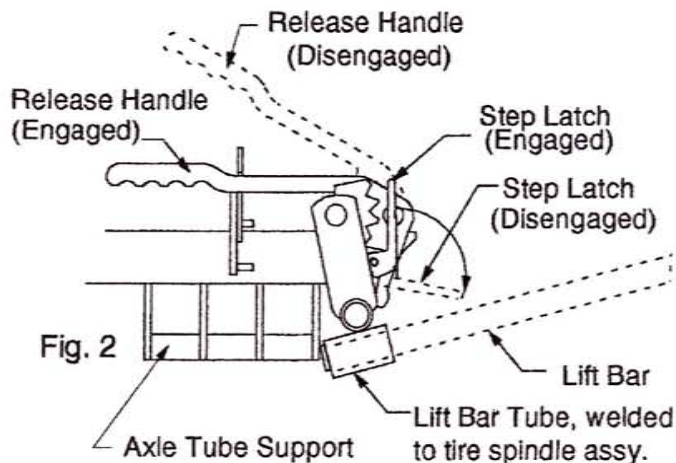

**Diversified Products Mfg.**

8330 Atlantic Blvd, Jacksonville Fl. 32211  
800-874-4172, 904-724-0310, Fax 904-724-4494

Rev. 7-2009

# WD-5400 Series Self-loading Dolly Owners Manual

## CAUTION:

Read and follow Owners Manual carefully before operating dollies.  
Keep BOTH HANDS firmly on the lift bar while raising or lowering the dolly.  
Always keep your HANDS and FEET out from under the dolly.  
Always load vehicle on a level surface.  
Always use tie-down straps to secure the dolly to the towed vehicle.  
Always drive safely and follow SAFE TOWING PRACTICES.  
Follow preventative maintenance requirements for proper operation.

## MAINTENANCE:

1) Always keep self loading dolly tires inflated to correct pressure to prevent premature wear and to trailer properly under full load conditions. Check pressure at least once every month. Verify correct psi on tires.  
2) Lubricate the release handle latch, the step latch mechanism, and the Axle adjustment plungers every 3 months with light oil.  
3) Lubricate all grease fittings every 3 months.  
4) Repack dolly wheel bearings every 12 months or more often if required.  
We use Mobil XHP222 Extra-High Performance Lithium Complex Grease, and we strongly recommend that you do so also. The Extra-High Performance Lithium Complex is recommended for severe operating conditions including water contamination, heavy shock loads, high-temperature operation and it has excellent rust/corrosion resistance and extends re-lubrication periods.

## DOLLY CAPACITY and LOAD RATINGS:

The WD-5400 series has a maximum rated capacity of up to 4000 lbs.  
The Load Rating of each model is limited by the tire rating, up to the Dollies 4000 lb. Max. rating.

4 Carlisle USA TRAIL 4.80x8B tires are rated at 2340 lbs.  
4 Carlisle USA TRAIL 5.70x8B tires are rated at 2860 lbs.  
4 Carlisle USA TRAIL 5.70x8C tires are rated at 3640 lbs.  
4 Carlisle USA TRAIL 5.70x8D tires are rated over the dolly's 4000 lb. Maximum rating.

We've used Carlisle USA Trail tires exclusively for more than 15 years. They have consistently shown that high quality AMERICAN MADE tires are better, more durable and perfectly matched to the needs of the commercial towing operator. Simply put... our customers do not have defective tire problems.

The B rated tires have always been standard equipment on our dollies, and should meet all typical dolly applications. We can supply higher rated tires if needed to meet your requirements.

Trailer tires are designed for maximum speeds of no more than 50 mph.  
Do not tow dollies above 50 mph or you will create a dangerous condition.  
Excessive speed can cause premature tire wear, bearing damage, or other failures that are not manufactured defects. Failure of the dollies due to any cause other than a manufactured defect is not covered by warranty.



## SPECIFICATIONS:

WD-5401 Dolly Side Frame w/4.80x8B tires  
O/A Length 45 3/4" (latched/loaded position)  
36 3/4" (min. storage position)  
Height 17"  
Width 10 1/2"  
Weight 78 lbs.

WD-5401L Dolly Side Frame w/5.70x8B tires  
O/A Length 47 3/4" (latched/loaded position)  
38 3/4" (min. storage position)  
Height 19"  
Width 10 3/4"  
Weight 88 lbs.

WD-5350 Adjustable Aluminum Axle Tubes  
Length 83" extended, 51" collapsed, Wt. 20 lbs.

WD-5350-1 Adjustable Aluminum Axle Tubes  
w/Dual Skid Pads  
Length 83" extended, 61" collapsed, Wt. 22 lbs.

WD-5330 Adjustable Steel Axle Tubes  
Length 83" extended, 51" collapsed, Wt. 50 lbs.

WD-5330-1 Adjustable Steel Axle Tubes  
w/Dual Skid Pads  
Length 83" extended, 61" collapsed, Wt. 52 lbs.

## **Diversified Products Mfg.**

8330 Atlantic Blvd, Jacksonville Fl. 32211  
800-874-4172, 904-724-0310, Fax 904-724-4494

# WD-5400 Series Self-loading Dolly Owners Manual



WD-5400 Series Replacement Parts:

Item#	Part#	Description
1a)	WD-66	4.80x8B Carlisle Tire & Wheel Assembly
1b)	WD-64	5.70x8B Carlisle Tire & Wheel Assembly
2	WD-65	Complete Hub Assembly (bearings, races, seal, cap, slotted jam nut, cotter pin etc.)
3	WD-5404L	Step Latch Lever Spring (Left)
4	WD-5404R	Step Latch Lever Spring (Right)
5	X-299	Flat Washer, 1/4" ZP
6	X-210	Locknut, 2-way, 1/4-20 ZP
7	WD-5403	Release Handle Spring
8	WD-5406	Step Latch Lever
9	WD-5420	Release Arm Latch Bracket w/1/4-20 studs
10	X-004	Hex Bolt, 1/4-20x1", ZP (to replace studs only)
11	WD-5407	Release Handle Latch
12	WD-5405	Release Handle Latch Spring
13	WD-242	5' Lift Bar

Not pictured/numbered:

WD-5401	Complete Dolly Side Frame Assembly w/4.80x8B Tires
WD-5401L	Complete Dolly Side Frame Assembly w/5.70x8B Tires
WD-5401X	Complete Dolly Side Frame Assembly w/o Tires/Wheels
WD-5402A	Complete Dolly Side Frame Assembly w/o Tires/Wheels/Hubs

WD-5350	Aluminum Adjustable Axle Tube (w/single skid pad)
WD-5350-1	Aluminum Adjustable Axle Tube (w/dual skid pads)
WD-5330	Steel Adjustable Axle Tube (w/single skid pad)
WD-5330-1	Steel Adjustable Axle Tube (w/dual skid pads)
TS-343	Spring for Adjustable Axle Tubes
WD-5339	Locking Plunger for Adjustable Axle Tubes

WD-47	Dust Cap
WD-48	Bearing
WD-49	Grease Seal
X-756	Slotted Jam Nut 1" NF (Castle Nut) ZP
X-352	Cotter Pin (1/8"x1 3/4")

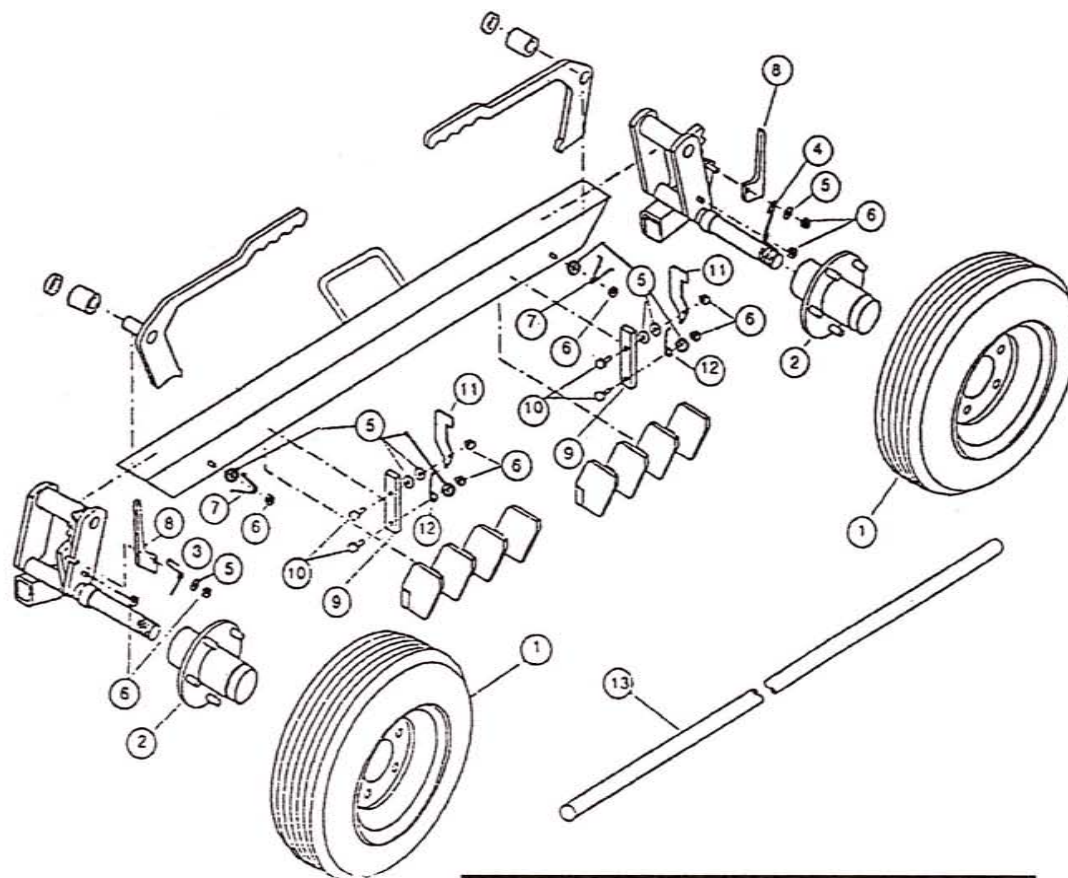

## Diversified Products Mfg.

8330 Atlantic Blvd, Jacksonville Fl. 32211  
800-874-4172, 904-724-0310, Fax 904-724-4494

# WD-5400 Series Self-loading Dolly Owners Manual



## Optional Bracket Kits and Accessories

### Dolly Side Frame Storage Brackets:

WD-5260 Tall Bracket Kit (9 9/16") for 4.80x8 Dollies

WD-5260T Tall Bracket Kit (12 1/16") for 5.70x8 Dollies

WD-5260S Short Bracket Kit (3 5/8") for all Dollies

Allows either 4.80x8 or 5.70x8 Dollies to be stored unlocked/unlatched. Many operators prefer the short brackets because the dollies take up less deck space in the unlocked/unlatched position.

WD-5280 Angle-mounted Dolly Bracket Kit

Allows 4.80x8 Dollies to be stored in a tilted-back orientation. This eliminates having to lift the dolly in/out of the brackets. It's easier to tilt it forward/backwards and position the dolly into the storage bracket.

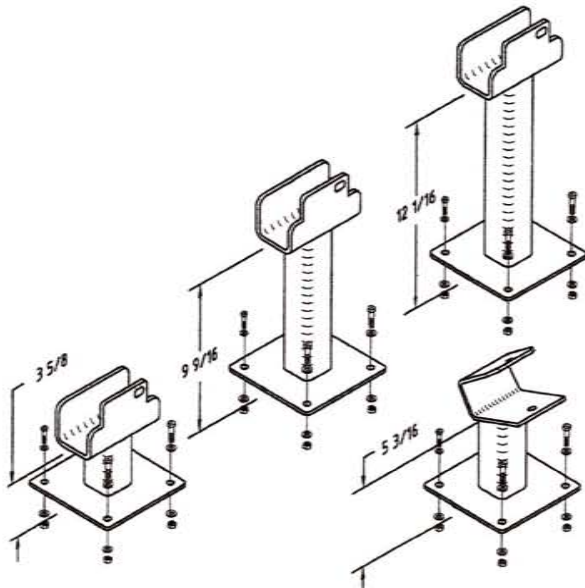

### Dolly Tube Storage Brackets:

WD-5250 Dolly Tube Storage Bracket Kit

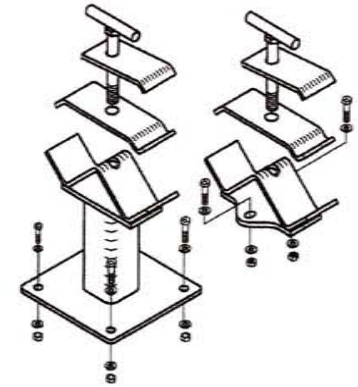
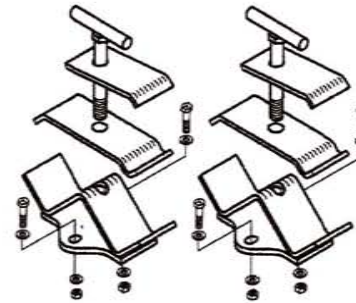

WD-5290 Offset (5 5/16")  
Dolly Tube Storage Bracket Kit  
For use on Dynamic bodies.

### Also Available:

MP-1313 Tie-Down Straps (pr.) Required for safe dolly towing

Tie-Down Straps should always be used whenever a vehicle is being towed on dollies. They secure the dolly to the vehicle and insure that it can't separate from the dolly. Separation can occur to an unsecured vehicle in a panic stop, on impact with a deep pothole, or even from contacting a low shoulder on the roadside. Properly secured Tie-Down Straps will not allow separation.

WD-5270 Dolly Wheel Pans (pr.)

Used to convert a Self-Loading Dolly into a conventional Pan Dolly. In some instances, it's best to set the dolly up conventionally, and lift the vehicle into the dolly, such as if the wheels/tires have been removed. The Wheel Pans do not allow Self-Loading operations, but they do give you another option for unusual situations.

## Diversified Products Mfg.

8330 Atlantic Blvd, Jacksonville Fl. 32211  
800-874-4172, 904-724-0310, Fax 904-724-4494

Rev. 7-2009